

# AURORA ACCESSORIES

## 3DV™ COMBINATION VALVE

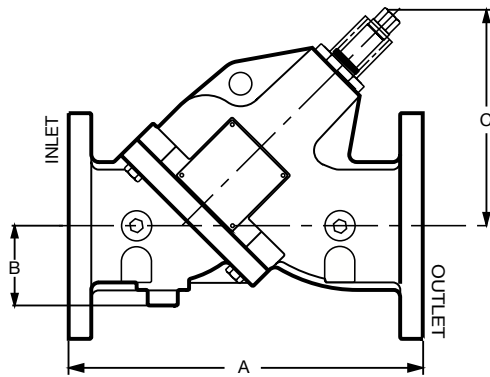

(IN-LINE, AS SUPPLIED)

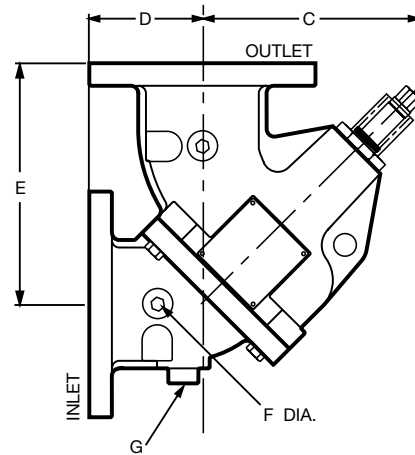

(90° FIELD CONVERTED)

DIMENSION IN INCHES (mm)									
MODEL	INLET & OUTLET	A	B	C	D	E	F (NPT)	G (PIPE SIZE)	WEIGHT LBS. (kg)
3DV125	1-1/4 NPT	6.50 (165)	1.18 (30)	4.25 (108)	2.63 (67)	3.88 (98)	1/4	1/2	7.25 (3.3)
3DV150	1-1/2 NPT	7.00 (178)	1.38 (35)	4.38 (111)	2.93 (74)	4.13 (105)	1/4	1/2	8.25 (3.7)
3DV2	2 NPT	8.00 (203)	1.75 (44)	4.50 (114)	3.00 (76)	5.00 (127)	1/4	1/2	12 (5.4)
3DV250 THD	2-1/2 NPT	11.88 (302)	2.38 (60)	7.13 (181)	3.63 (92)	8.25 (210)	1/4	1	32 (14.6)
3DV250 FLG	2-1/2 FLANGE	10.63 (270)	2.38 (60)	7.13 (181)	3.00 (76)	7.63 (194)	1/4	1	43 (19.5)
3DV3	3 FLANGE	11.75 (298)	2.63 (67)	7.38 (187)	3.75 (95)	8.00 (203)	1/4	1	49 (22.0)
3DV4	4 FLANGE	13.88 (353)	3.13 (80)	7.63 (194)	4.30 (109)	9.63 (245)	1/4	1-1/4	76 (34.5)
3DV5	5 FLANGE	17.63 (448)	3.63 (92)	9.13 (232)	5.25 (133)	12.38 (314)	1/4	1-1/4	100 (45.4)
3DV6	6 FLANGE	20.38 (518)	4.50 (114)	9.75 (248)	6.13 (156)	14.25 (362)	1/4	2	190 (86.2)
3DV8	8 FLANGE	25.88 (657)	5.88 (149)	15.00 (381)	7.88 (200)	18.00 (457)	1/4	2	380 (172)
3DV10	10 FLANGE	30.00 (762)	7.13 (181)	17.00 (432)	10.00 (254)	20.00 (508)	1/4	2	610 (277)
3DV12	12 FLANGE	36.00 (914)	8.50 (216)	20.00 (508)	12.00 (305)	24.00 (610)	1/4	2	1140 (517)

**NOTES:**

- All dimensions in inches (mm).
- Dimensions may vary  $\pm 1/8$  (3).
- Maximum working temperature 230°F.
- "G" is boss for pipe support (supplied by others). Boss to fit inside pipe size listed (sch 80/40).
- Maximum working pressure 175 P.S.I.
- Not for construction purposes unless certified.
- Outlet and inlet flanges - 125# ANSI flat face. (2-1/2 and larger)

THIS PAGE LEFT INTENTIONALLY BLANK